

# Gillies Resilient Seated Gate Valves

Technical Guide W4.76

Gillies Resilient Seated Gate Valves are designed and manufactured to AS/NZS 2638.2. These valves are suitable for use in potable water and for installation above or below ground.



## Applications

Potable water networks, Bulk water storage, Process water systems, Pump stations, Neutral liquids without solids

## Product Attributes

PN16 Rated  
Available as Anti-Clockwise and Clockwise Closing

Smooth straight through bore

Suitable for actuation

## Approvals/Standards

AS/NZS 2638.2:2011 Gate Valves for Water Works – Resilient Seated

Flanges drilled to AS/NZS 4087 Fig. B5

Coating complies with AS/NZS 4158 and AS/NZS 4020 for potable water

## Quality/Environment/Health & Safety

Hynds management systems are certified to ISO 9001:2015, 45001:2015, and 14001:2018 standards



Licence Number:  
23494



Appraisal Number:  
PA 2508



Licence Number:  
4085

*We are the supply partner of choice for New Zealand's civil construction industry, specialising in water and infrastructure based solutions.*

**HYND**water

Gillies Resilient Seated Gate Valves are manufactured from high strength and corrosion resistant materials to provide reliable service in potable water networks. These valves are PN16 rated, available in DN80 – DN600 as anti-clockwise or clockwise closing.

#### Product Features

- Suitable for above ground or underground installation.
- Anti-clockwise closing or clockwise closing available.
- Smooth straight-through bore prevents debris build up and allows for easy cleaning with a pig.
- Ductile Iron body and bonnet for high strength and impact resistance.
- Ductile Iron wedge fully encapsulated by EPDM elastomer to ensure a drip tight seal.
- Spindle O-Rings are replaceable under operating pressure.
- Fusion Bonded Epoxy coating to AS/NZS 4158 provides long lasting corrosion protection.
- 431 Grade Stainless Steel Stem and 316 Grade Stainless Steel Bolts for high corrosion resistance.

#### Accessories

- Supplied with Spindle Cap as standard.
- Handwheels available as optional.
- Actuator Adaptor with ISO flange drilling available as optional.

#### Technical Specifications

- Size Range: DN80 – DN600
- Complies with AS/NZS 2638.2:2011
- Flanges drilled to AS/NZS 4087 Fig. B5
- Coating complies with AS/NZS4158
- Potable water compliant to AS/NZS 4020
- Maximum operating temperature: 40°C
- Allowable operating pressure: 16 Bar
- This product complies with the requirements of Lead-Free Standards as defined in the National Construction Code Volume 3 and is suitable for use as part of Lead-Free installation.

#### Installation

- Suitable for above or below ground installation in accordance to relevant local authority requirements and regulatory codes.



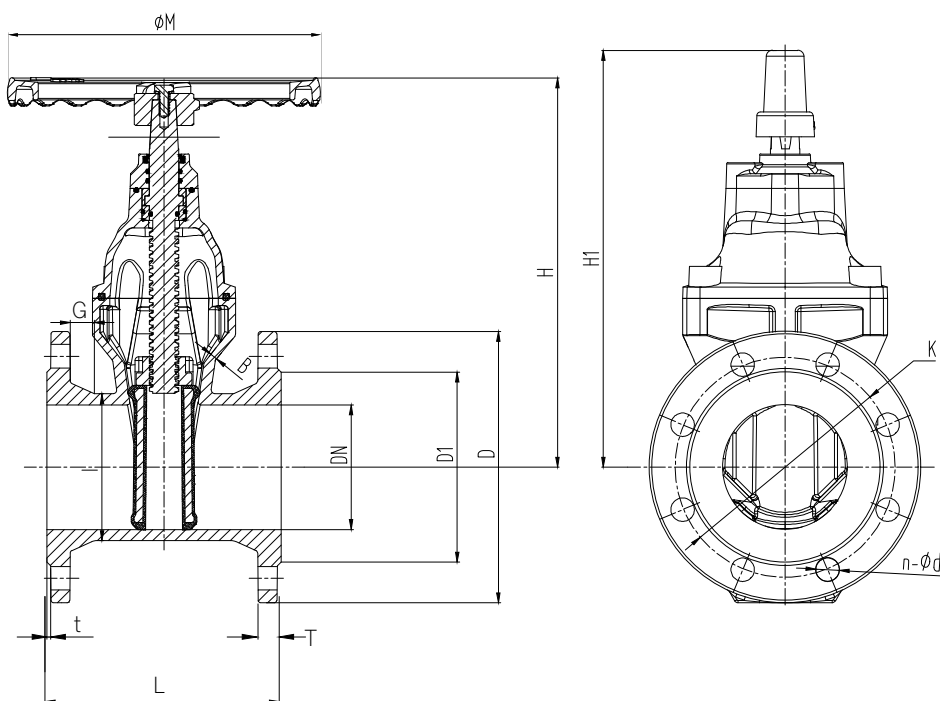

Code	DN	CONNECTING FLANGE							Turns to Close	Closing Torque (Nm)	M	H	H1	Weight (kg)
		L	D	D1	K	n-Ød	T	t						
VGRS080	80	203	185	122	146	4-Ø18	18	3	11	60	Ø200	275	290	12
VGRS100	100	229	215	154	178	4-Ø18	20	3	12	80	Ø220	320	335	19
VGRS150	150	267	280	211	235	8-Ø18	23	3	17	120	Ø280	400	410	33
VGRS200	200	292	335	268	292	8-Ø18	23	3	18.5	150	Ø315	495	545	50
VGRS225	225	305	370	300	324	8-Ø18	24	3	23	200	Ø406	555	545	76
VGRS250	250	330	405	328	356	8-Ø22	24	3	23	200	Ø406	590	640	79
VGRS300	300	356	455	378	406	12-Ø22	30	4	27	250	Ø406	670	720	107
VGRS375	375	381	550	463	495	12-Ø26	33	4	34	350	Ø500	820	900	211
VGRS450	450	432	640	552	584	12-Ø26	33	4	28	400	Ø650	980	1030	293
VGRS500	500	457	705	609	641	16-Ø26	35	4	32	450	Ø650	1050	1100	354
VGRS600	600	508	825	720	756	16-Ø30	42	5	34	550	Ø650	1245	1295	586

**Note:** Clockwise Closing Valves are available on request.

Code	Valve Size (mm)	Handwheel Closing Direction
VGHW080-ACC	80	ACC
VGHW080-CC	80	CC
VGHW100-ACC	100	ACC
VGHW100-CC	100	CC
VGHW150-ACC	150	ACC
VGHW150-CC	150	CC
VGHW200-ACC	200	ACC
VGHW200-CC	200	CC
VGHW225-300-ACC	225-300	ACC
VGHW225-300-CC	225-300	CC
VGHW375-ACC	375	ACC
VGHW375-CC	375	CC
VGHW450-600-ACC	450-600	ACC
VGHW450-600-CC	450-600	CC

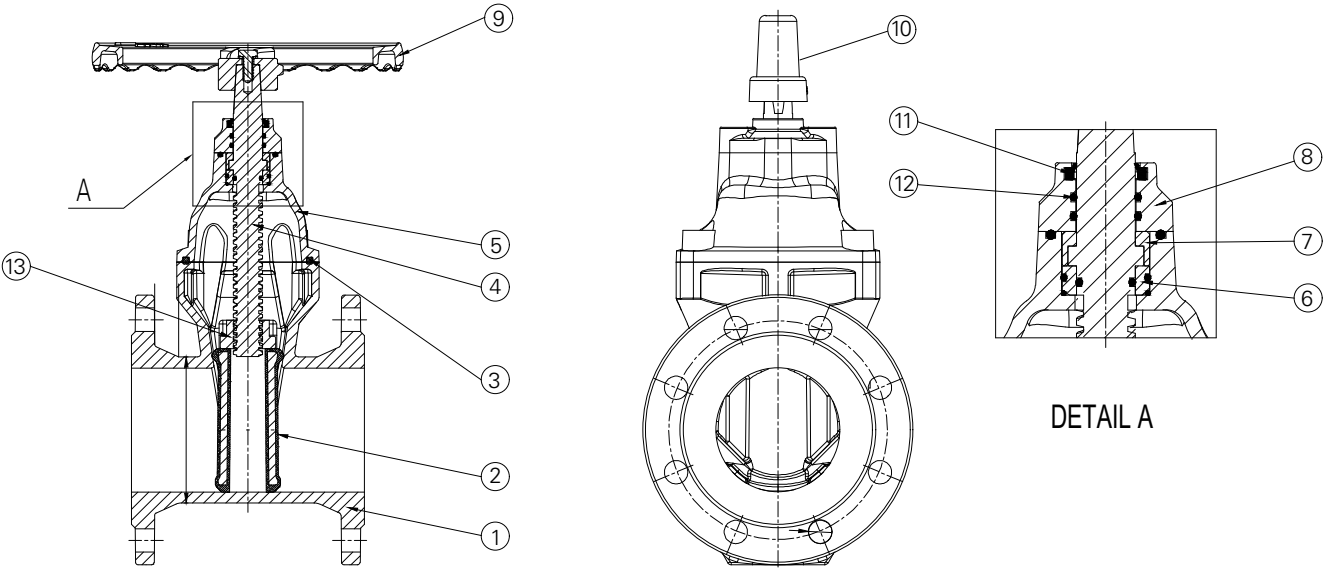

No.	Component	Material
1	Body	Ductile Iron (500-7)
2	Wedge	EPDM + Ductile Iron (500-7)
3	Bonnet Gasket	EPDM (WRAS)
4	Stem	AISI431 Stainless Steel
5	Bonnet	Ductile Iron (500-7)
6	Thrust Washer	Bronze (C95210)
7	Thrust Sleeve	Bronze (C95210)
8	Gland	CF8M Stainless Steel
9&10	Handwheel/Cap	Ductile Iron (500-7)
11	Dustcover	NBR
12	O-Ring	EPDM (WRAS)
13	Stem Nut	Bronze (C95210)

Branches Nationwide Support Office & Technical Services 0800 93 7473

**Disclaimer:** While every effort has been made to ensure that the information in this document is correct and accurate, users of Hynds product or information within this document must make their own assessment of suitability for their particular application. Product dimensions are nominal only, and should be verified if critical to a particular installation. No warranty is either expressed, implied, or statutory made by Hynds unless expressly stated in any sale and purchase agreement entered into between Hynds and the user.